

"LUCKY" HI-TECH BUILDING SYSTEM

DEVELOPED FROM ISO STANDARD

CONFORMING TO JAPANESE CONSTRUCTION REGULATION UP TO 4 STOREYS



PRODUCTION



INLAND TRANSPORTATION



OCEAN TRANSPORTATION



INSTALLATION



Disneyland, Hong Kong



HIGH QUALITY "LUCKY" HI-TECH BUILDING SYSTEM FOR

- MANSION
- DORMITORY
- RESORT & HOTEL
- OFFICE
- TRAINING CENTER
- CONVENIENCE STORE & KIOSK
- SCHOOL
- HOSPITAL / MOBILE CLINIC
- NURSERY
- CABINET FOR TELECOM SYSTEM
- TOILET UNIT
- MOTORCYCLE STORAGE UNIT
- MULTI-USE STORAGE UNIT
- PREFABRICATED EMERGENCY HOUSE
- OTHER MULTI-PURPOSED APPLICATIONS



SIAM STEEL GROUP COMPLEX
HEAD OFFICE & POOCHAO FACTORY
TOTAL AREA 240,000 M²

SIAM STEEL
INTERNATIONAL P.L.C.
SIAM STEEL ISO 9001 ISO 14001 OHSAS 18001



SIAM STEEL GROUP COMPLEX
BANGNA FACTORY
TOTAL AREA 160,000 M²

SIAM STEEL
INTERNATIONAL P.L.C.
SIAM STEEL ISO 9001 ISO 14001 OHSAS 18001



SIAM STEEL GROUP COMPLEX
RAYONG FACTORY
TOTAL AREA 2,560,000 M²

SIAM STEEL
INTERNATIONAL P.L.C.
SIAM STEEL ISO 9001 ISO 14001 OHSAS 18001



INTRODUCTION 紹介	_____	4	
MODULAR MANSION モジュール マンション	_____	10	
MODULAR BUSINESS HOTEL モジュール ビジネスホテル	_____		
MINING ACCOMMODATION 鉱業宿泊施設	_____	11	
OFFICE オフィス	_____	13	
OFFICE & ACCOMMODATION UNIT オフィス & 宿泊ユニット	_____	15	
SHOWROOM ショールーム	_____	16	
CONVENIENCE STORE & KIOSK コンビニエンスストア & キオスク	_____	17	
MULTI-USE STORAGE UNIT 多目的用の収納ボックス	_____	19	
MOTORCYCLE STORAGE UNIT バイクの収納ボックス	_____	20	
CABINET UNIT FOR TELECOM SYSTEM 通信移動施設	_____	21	
TOILET & BATHROOM UNIT 仮設バス & トイレ ユニット	_____	22	
PREFABRICATED EMERGENCY HOUSE 非常プレハブハウス	_____	23	

"LUCKY" Hi-tech Building System is manufactured by Siam Steel International Public Company Limited which is the affiliated company of Siam Steel Group.

Siam Steel Group was founded since 1953 and has operated under the international joint-venture basis involving in 5 product categories :-

1. Construction materials group
2. Industrial goods group
3. Vehicle group
4. Furniture group
5. Service group

At present (2012), Siam Steel Group is comprised of 29 companies and the total annual turnover of the group is two billion USD.

Siam Steel International Public Company Limited, the listed company on the Stock Exchange of Thailand which was founded in 1953, is the leading manufacturer of steel products including **steel furniture** under the trademark "LUCKY", "King-Dom", "Okamura", "Chitose", "Pilot" and "**LUCKY**" **Hi-tech Building System**. Apart from the quality approval from Thai and other international standard institutes, the Company has attained **ISO 9001, ISO 14001, TIS/OHSAS 18001 Certificates, CSR-DIW** (Standard for Corporate Social Responsibility) **Certificate** as well as **Carbon Footprint for Organization and Green Industry ; Level 3 Green System Certificates** and was approved to use the **Green Label** and **Thailand Trust Mark Logo**. This implies the strong intension in continuously develop the quality system of the Company.

サイアムスチールインターナショナル(株)

ハイテクビルディングシステム「ラッキー」は、サイアムスチールグループ系列のサイアムスチールインターナショナル(株)に開発されました。

サイアムスチールグループは1953年に創立され、国際的な合弁事業は5つに分類されます：

1. 建材部門
2. 工業製品部門
3. 自動車部門
4. オフィス家具部門
5. サービス部門

現在 (2012)、サイアムスチールグループは 29 社に構成され、年間総売上 20 億ドルになっています。

タイ国証券取引所上場のサイアムスチールインターナショナル(株)は1953年に設立され「ラッキー」、「キングドム」、「オカムラ」、「チトセ」、「パイロット」の家具、また「ラッキー」ハイテクビルディングシステムの商標で鉄鋼製品の主導的な業者になっています。タイおよび 国際機関認証の品質マネジメントシステムのほか、当社はISO 9001, ISO 14001, TIS/OHSAS 18001 従って CSR-DIW (社会的責任を協力するための標準) 認証を受けて、及びカーボンプットプリントの組織とグリーン産業、グリーンのシステムレベル3証明書 にグリーンラベルとタイトラストマークのロゴ認証を受けました。これらは、当社の品質システムの継続的な開発を強力に推進します。

"LUCKY" Hi-tech Building System



International quality standard & its advantages

- Capable to manufacture according to ISO and other international standards such as BS, DIN, ASTM including Japanese industrial standard
- Strength and safe because made of special designed steel structure
- Available in complete unit and knock-down system including flat-packed system
- Building can be completed in factory for more than 90%
- Capable to design for withstanding temperature -30°C to $+50^{\circ}\text{C}$ (-24°F to $+140^{\circ}\text{F}$)
- Capable to design for strong wind resistance up to Hurricane
- Earthquake resistance because made of special designed steel structure
- Fire resistance up to 60 minutes
- Capable to design for heavy snow bearing in accordance with each local condition
- Energy saving because made of special insulated material
- Transportation cost and erection cost saving
- Capable to be loaded and transported to site by truck, ship and helicopter
- Can be easily erected and dismantled to move to another site
- Capable to design for erection without crane or special tools
- Built-in electrical system, gas, water pipe, drain-pipe including bioseptic pipe are also available
- "LUCKY" Hi-tech Building System is easy to modify, install, add on and move. In addition, it can be expanded with unlimited length and width and can also be added on up to four stories according to the standard with only one day installation. For more than four stories height, it can be special designed.

「ラッキー」ハイテクビルディングシステム

国際的品質規格および利点

- ISOまたはBS、DIN、ASTM、JISなどの国際規格に基づいて生産できます。
- 特殊鉄鋼を使用し、強度と安全性が優れます。
- フラットパック システムを含めて既製またはノックダウンで販売されます。
- 90%以上の構造が工場内で完成されます。
- -30°C - $+50^{\circ}\text{C}$ (-24°F - $+140^{\circ}\text{F}$) の使用温度
- ヘリケーンまで、強風に耐える設計可能。
- 特殊鉄鋼により、耐震が優れます。
- 60分間の耐火性能。
- 地元の条件により耐雪荷重設計ができます。
- 特殊防熱材により、省エネルギーが優れます。
- 運搬費と構築費を節約できます。
- トラック、船舶またはヘリコプターで現場まで運搬できます。
- 簡単に構築・分解、また移動ができます。
- クレーンまたは特殊工具なしに構築できます。
- 電力、ガス、上水道、排水、また下水管搭載システムも選択できます。
- 「ラッキー」ハイテクビルディングシステムの変更、設置、増築および移動が便利です。その上、長さ・幅の拡張は無限で、建築規格上の4階層まで1日に構築できます。なお、4階層を超える場合は、特別設計を必要とします。

"LUCKY" Hi-tech Building System



Wide variety of uses

"LUCKY" Hi-tech Building System is designed to meet a wide variety of uses as under :-

- **Type 1 : Permanent Buildings;** for long term usage which can be built in 2 systems :-
 - 1.1 **Complete Unit System** : same size as ISO marine container and will be transported according to ISO marine container system.
 - 1.2 **Knock-Down System** : different size from ISO marine container, therefore, they are manufactured in knock-down including flat-packed system for transportation cost saving.
Example of usages
 - Mansion
 - Business Hotel
 - Convenience Store
 - Showroom
 - Mobile Office
- **Type 2 : Temporary Buildings ;** for convenient relocation to various places, therefore, they are manufactured in knock-down including flat-packed system.
Example of usages
 - Mobile Office
 - Mobile Clinic
 - Mobile Toilet
 - Convenience Store
 - Mini Shop
 - Showroom
- **Type 3 : Special Buildings ;** are specifically designed for each usage. They are available both in permanent building and temporary building, for example :
 - 3.1 **Fast Food Shop** : special Mobile Kitchen and Mobile Cold Storage Room are designed for easy relocation and installation, thus, the shops can be opened in the short period.
 - 3.2 **Telecom Shelter** : special shelters are designed for installation of all telecommunication system which need to control all circumstances of shelter including temperature, water-proof and damp-proof. Our customer includes Nokia, Siemens, Ericsson, Motorola, Huawei, etc.
 - 3.3 **Warehouse Unit** : the units are designed to serve general storage and specific storage for both indoor and outdoor usage such as motorcycle storage unit, multi-use storage unit for rent, etc.
 - 3.4 **Soundproof Room** : excellent soundproof for multi-purpose usages including musical instrument practice room, recording / edit room, sound lab, office in the industrial plant, etc.

「ラッキー」ハイテクビルディングシステム

幅広い用途

「ラッキー」ハイテクビルディングシステムは以下の幅広い用途に設計されています。

- **タイプ1 : 本設ビルディング : 2システムにわたる長期的な用途。**
 - 1.1 本体完成品システムビルディング (現場でジョイント及び給、排水接直等) : ISO海上コンテナと同寸法および同様な出荷システム
 - 1.2 ノックダウン システム : ISO海上コンテナと寸法が違い、運搬の利点にはフラット パック システムを含めてノックダウンで生産されます。
用途の例
 - マンション
 - ビジネスホテル
 - コンビニエンスストア
 - ショールーム
 - 仮設事務所
- **タイプ2 : 仮設なビルディング : 各現場間の移動をねらい、フラット パック システムを含めてノックダウン方式に生産されます。**
用途の例
 - 仮設事務所
 - 仮設医療所
 - 仮設トイレ
 - コンビニエンスストア
 - ミニショップ
 - ショールーム
- **タイプ3 : 用途に応じて特殊設計ビルディング : 用途別に生産されます。以下のように、固定または一時的な用途にしてもよい。**
 - 3.1 **ファストフード ショップ** : 特殊移動キッチンおよび移動冷蔵庫は移動と設置の便を図り、開店の時期を短縮できます。
 - 3.2 **テレコムシェルター** : 特殊の建造物など特殊な通信機器を設置できるが、温度、雨水、湿気の対策ができます。弊社の得意先にはNOKIA、SIEMENS、MOTOROLLA、HUAWEIなどがあります。
 - 3.3 **倉庫ユニット** : このユニットは一般および特殊の用途に設計され、オートバイ、貸切用多目的ユニットなど、屋内外に利用できます。
 - 3.4 **防音室** : 音楽練習所、録音・編集室、音響スタジオ、工場内事務所など防音効果が優れます。

MANSION PERMANENT BUILDING; COMPLETE UNIT

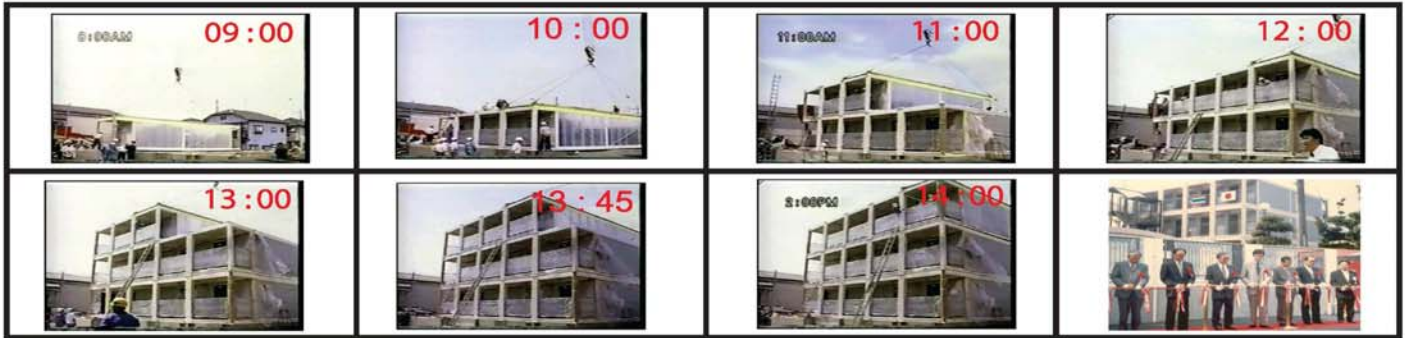

CONVENIENCE STORE PERMANENT BUILDING; KNOCK-DOWN SYSTEM

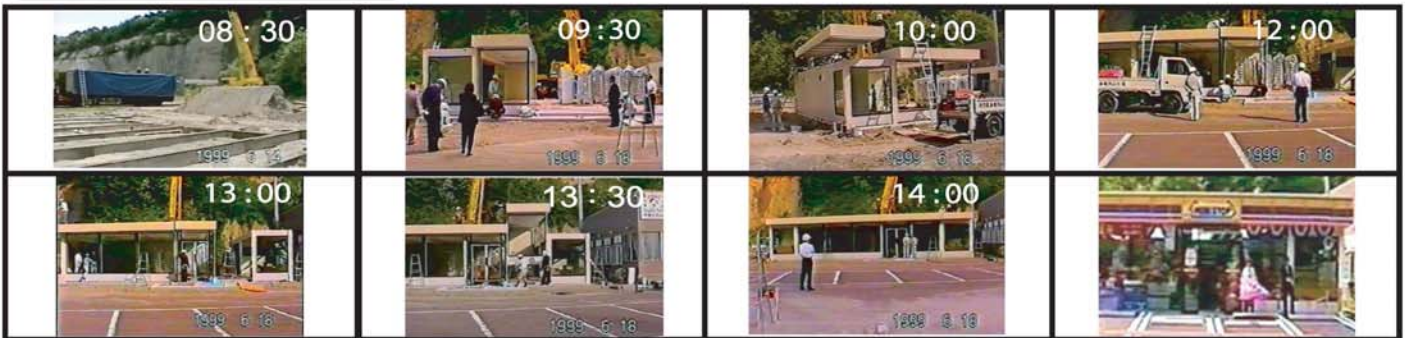

MOBILE OFFICE PERMANENT BUILDING; KNOCK-DOWN SYSTEM



MOBILE OFFICE TEMPORARY BUILDING; KNOCK-DOWN SYSTEM



MOBILE OFFICE TEMPORARY BUILDING; KNOCK-DOWN SYSTEM
NO CRANE AND SPECIAL TOOLS REQUIRED



PACKING & LOADING

COMPLETE UNIT PACKING : LOADING SAME AS ISO MARINE CONTAINER



KNOCK-DOWN PACKING : FLAT PACKED SYSTEM; CAN LOAD 8 UNITS IN ONE 40' CONTAINER



KNOCK-DOWN PACKING : CAN LOAD 13 UNITS IN ONE 20' CONTAINER



TRANSPORTATION & UNLOADING

COMPLETE UNIT : TRANSPORTATION SAME AS ISO MARINE CONTAINER



COMPLETE UNIT



UNLOADING FROM VESSEL



LOADING ON TRUCK



INSTALLATION AT SITE

KNOCK-DOWN SYSTEM



UNLOADING FROM VESSEL



UNLOADING FROM CONTAINER



INSTALLATION AT SITE

MODULAR MANSION

JAPAN : 4-STOREY MANSION 76 UNITS



LOBBY



CORRIDOR



BEDROOM



KITCHEN UNIT



ELECTRICAL CONTROL PANEL



TOILET UNIT



DRAIN PIPE FOR BATHROOM UNIT
BIO SEPTIC PIPE
DRAIN PIPE FOR KITCHEN
WATER PIPE



BATHROOM UNIT

MODULAR BUSINESS HOTEL

JAPAN : 3-STOREY BUSINESS HOTEL

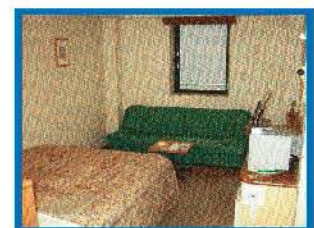

BEDROOM



ENTRANCE AREA

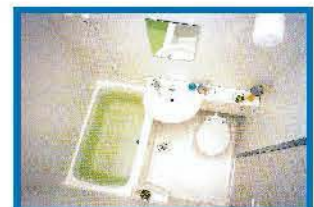

TOILET & BATHROOM UNIT

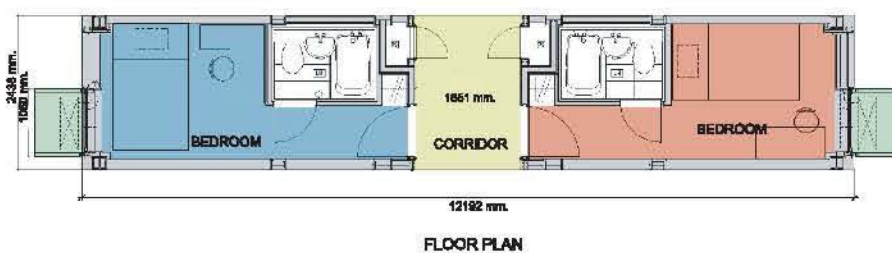

MINING ACCOMMODATION

AUSTRALIA : 4 - MAN EXPANDABLE ACCOMMODATION UNIT WITH TOILET

THE WORLD'S BIGGEST OIL AND GAS PROJECT EVER BUILT IN 2009



INSTALLATION



BEDROOM



KITCHEN / DINING ROOM



FLOOR PLAN



ENTERTAINMENT AREA

MINING ACCOMMODATION

AUSTRALIA : APARTMENT STYLE ACCOMMODATION



GROUND FLOOR



FIRST FLOOR



AUSTRALIAN CAMP IN LAOS : 4 - MAN EXPANDABLE ACCOMMODATION UNIT WITH TOILET



FLOOR PLAN



BEDROOM



BEDROOM



BEDROOM



SHOWER ROOM & TOILET

OFFICE

JAPAN : 2002 WORLD'S CUP SOCCER OFFICE

FIFA WORLD CUP
KOREA JAPAN



OFFICE



MEETING ROOM



MEETING ROOM



BROADCASTING ROOM



CANTEEN



EASY TO ADJUST THE POSITION OF WINDOWS & DOORS OR ADD THE WINDOWS & DOORS TO MEET EACH REQUIREMENT

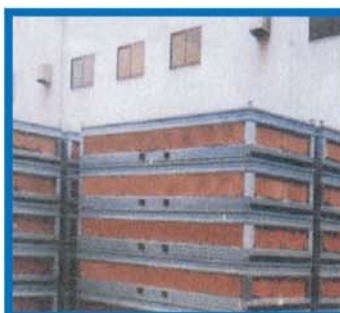

COMPACT PACKING AND SAVING AREA FOR STORAGE



CAN BE LOADED 8 UNITS INTO 40' CONTAINER

OFFICE

MIDDLE EAST : MOBILE CLINIC



- WASHBASIN
- AIR CONDITIONER
- VENTILATION FAN
- FLASHLIGHT
- MEDICINE CABINET
- LOCKER

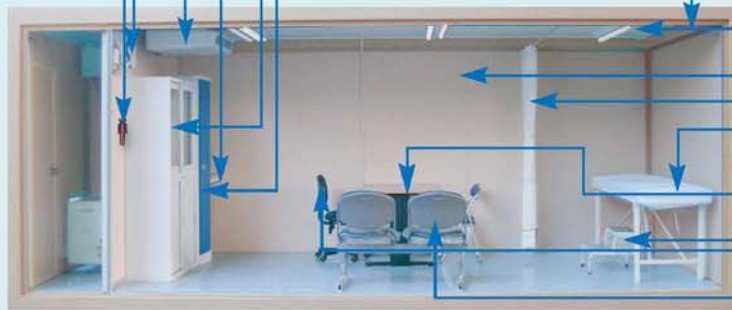

- THERMAL INSULATED ROOF & CEILING
- PANEL
- CURTAIN
- EXAMINATION COUCH
- TWO-STEP FOOTSTOOL
- EXAMINATION TABLE
- TWO FOLDING CHAIRS
- DOCTOR'S CHAIR WITH CASTER
- TWO WAITING CHAIRS

OFFICE & ACCOMMODATION UNIT



JAPAN : 2 - STOREY UNIT HOUSE FOR RELIEF OF DISASTER

THAILAND : 1 - STOREY LIBRARY BUILDING

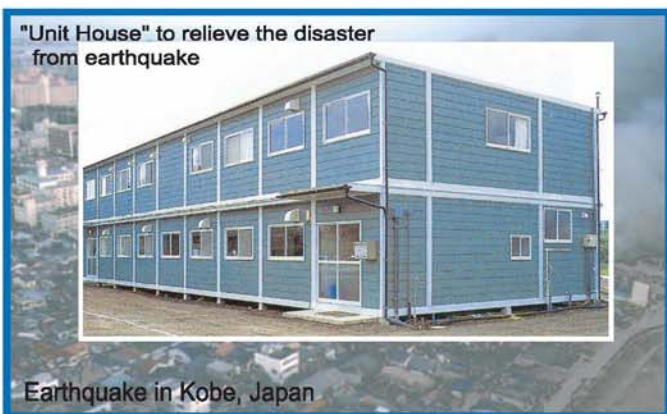

OFFICE & ACCOMMODATION UNIT



ARCHED PANEL BUILDING

ARCHED PANEL (VERTICAL)

R45 - PANEL



R90 - PANEL



ARCHED PANEL (HORIZONTAL)

R45H - PANEL



R90H - PANEL



Mini Coffee Shop



Food & Drink Kiosk



Fast Food Shop



ATM Booth



Books Kiosk



Resort Home



FLAT PACK : SIZE 2300(W) x 5400(L) x 2600(H) MM

QH-54FP-1X12 2300(W) x 5400(L) mm

QH-54S 2300(W) x 5400(L) mm



SINGLE STOREY CAN BE APPLIED TO DOUBLE STOREY



FOLDING TYPE

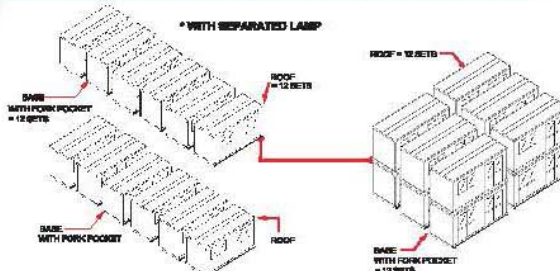
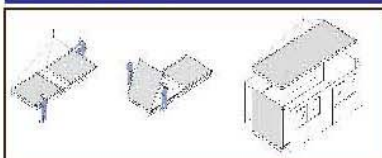

KNOCK DOWN TYPE

TRANSPORT BY 40R HIGH CUBE CONTAINER = 12 UNITS (8+8)

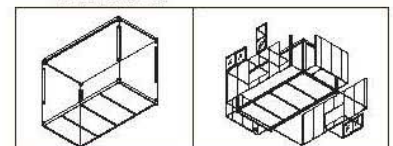

SHOWROOM

for ● Gasoline Station, Bus Station, Railway Station, Food Center, Convenience Store, Mobile Shop, Office Building Complex, Product Booth, Community Center, etc.

JAPAN : SHOWROOM & SHOP



ENTRANCE



DISPLAY AREA



DISPLAY AREA

JAPAN : MOBILE PHONE SHOP



CONVENIENCE STORE & KIOSK

JAPAN : CONVENIENCE STORE



CASHIER



DISPLAY AREA

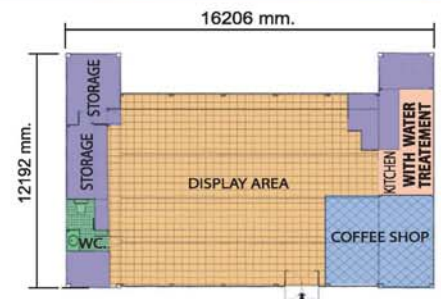

THAILAND : ENERGY SAVING CONVENIENCE STORE



DISPLAY AREA



DISPLAY AREA



CONVENIENCE STORE & KIOSK

THAILAND : FAST FOOD SHOP



COLD STORAGE ROOM



KITCHEN

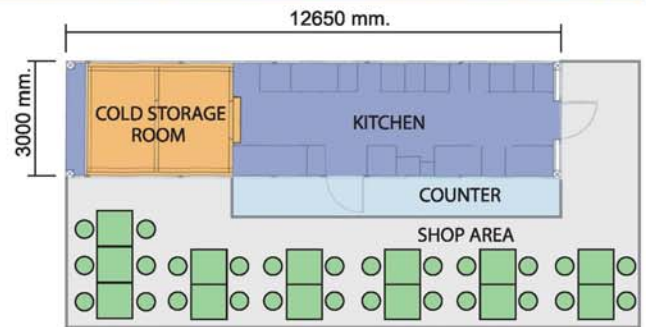

THAILAND : FAST FOOD SHOP



INSIDE SHOP : COUNTER



KITCHEN

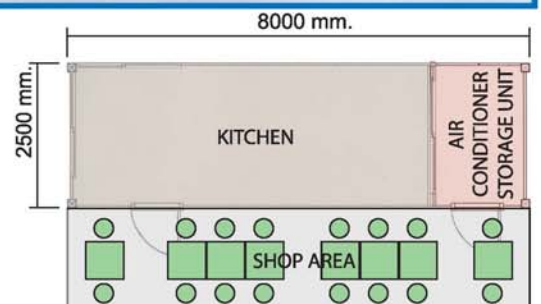

MULTI-USE STORAGE UNIT

OUTDOOR USAGE



STORAGE UNIT, 1 - 6 DOORS TYPE
 SIZE 2438 (W) x 6058 (L) x 2592 (H) mm.



STORAGE UNIT, 2 DOORS TYPE
 SIZE 1975 (W) x 1975 (L) x 2170 (H) mm.



INDOOR USAGE



STORAGE UNIT
 SIZE 900 (W) x 1800 (L) x 2100 (H) mm.



MOTORCYCLE STORAGE UNIT



SAFETY UNIT FOR ALL BRANDS



MBL-120 : 420 (W) x 1240 (D) x 470 (H) mm.
 MBL-261 : 420 (W) x 2650 (D) x 470 (H) mm.



INSULATED PANEL WITH ROLLER SHUTTER
 SIZE : 1400 (W) x 2700 (D) x 1900 (H) mm.



MBL-120 : 420 (W) x 1240 (D) x 470 (H) mm.
 MBL-261 : 420 (W) x 2650 (D) x 470 (H) mm.



SIZE : 1400 (W) x 2700 (D) x 1900 (H) mm.

OTHERS



GUARDSMAN BOX
 SIZE : 1500 (W) x 1500 (D) x 2400 (H) mm.



ATM CABINET
 SIZE : 2070 (W) x 3700 (D) x 2584 (H) mm.



RICE VENDING MACHINE KIOSK
 SIZE : 2070 (W) x 3700 (D) x 2584 (H) mm.

CABINET UNIT FOR TELECOM SYSTEM : KNOCK DOWN TYPE



● SUPPLIED TO



MOTOROLA



Sony Ericsson

SIEMENS



CDMA PROJECT



ON ROOF



ON GROUND

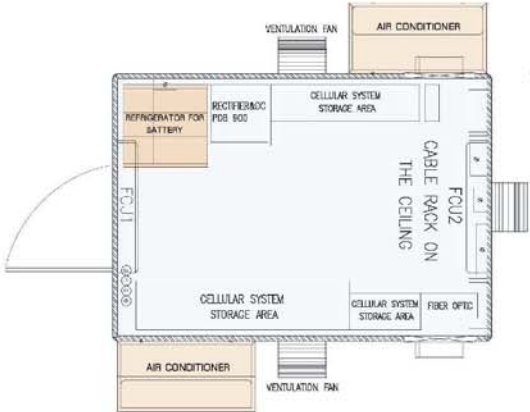

PAKISTAN PROJECT



MOBILE TYPE

MOBILE CABINET ON TRAILER FOR GOING AROUND

TOILET & BATHROOM UNIT

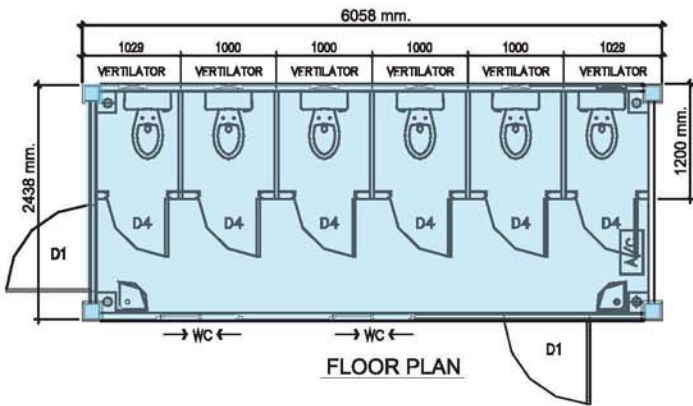

THAILAND : TOILET UNIT FOR ROYAL BRITISH EMBASSY



THAILAND : TOILET UNIT FOR THE 13th ASIAN GAMES BANGKOK 1998



JAPAN : TOILET UNIT FOR OUTDOOR EXHIBITION



LINK TOILET

LINK BATHROOM



MULTI-PURPOSE FOLDING UNIT

PREFABRICATED EMERGENCY HOUSE

INDONESIA : PREFABRICATED EMERGENCY HOUSE (TRANSITIONAL SHELTER TO RELIEVE THE DISASTER FROM TSUNAMI IN INDONESIA)

- KNOCK - DOWN SYSTEM; 13 HOUSING UNITS LOADED IN 20' CONTAINER
- SIMPLE TO ERECT; NO SPECIAL TOOLS OR CRANE REQUIRED
- RESISTANT TO EARTHQUAKE AND STRONG WIND



FIBER CEMENT SIDING; OVERLAP PANEL



FIBER CEMENT SIDING; OVERLAP PANEL



CONCRETE SIDING; FLAT PANEL



TIMBER SIDING; OVERLAP PANEL



LIVING ROOM



BEDROOM



FIBER CEMENT SIDING; FLAT PANEL

TAIWAN : 2- STOREY HOUSING UNIT (TO RELIEVE THE DISASTER FROM EARTHQUAKE IN TAIWAN)



LIVING ROOM

PROJECT REFERENCE

 JAPAN : 3-STOREY MANSION 12 UNITS	 JAPAN : 4-STOREY MANSION 76 UNITS	 JAPAN : 3-STOREY MANSION 12 UNITS	 JAPAN : 3-STOREY MANSION 42 UNITS	 JAPAN : 3-STOREY MANSION 33 UNITS
 JAPAN : 3-STOREY MANSION 30 UNITS	 JAPAN : 2-STOREY MANSION 8 UNITS	 JAPAN : 3-STOREY MANSION 15 UNITS	 JAPAN : 4-STOREY BUSINESS HOTEL 72 UNITS	 JAPAN : 4-STOREY SERVICE APARTMENT 72 UNITS
 JAPAN : 3-STOREY BUSINESS HOTEL 78 UNITS	 MIDDLE EAST : 3-STOREY MULTI PURPOSE BUILDING	 AUSTRALIA : GORGON PROJECT 4,000 MAN CAMP	 AUSTRALIA : FMG PROJECT 720 MAN CAMP	 AUSTRALIA : MINING CAMP 200 MAN CAMP
 AUSTRALIA : MINING CAMP 1,000 MAN CAMP	 AUSTRALIA : TEMPORARY CAMP	 AUSTRALIA : KITCHEN	 AUSTRALIA : MINING CAMP FOR HIGH WIND AREAS, REGION D	 THAILAND : OFFICE FOR PTT PROJECT
 AFGHANISTAN : BRITISH ARMY CAMP	 AFGHANISTAN : SPA	 KUWAIT : ACCOMMODATION UNIT	 CANADA : EXPANDABLE UNIT : 3-IN-1	 KENYA : METAL WALL WAREHOUSE (UN-WFP)
 SRI LANKA : SOFT WALL WAREHOUSE (UN-WFP)	 IRAQ : MOBILE CLINIC	 SRI LANKA : ACCOMMODATION/OFFICE UNIT (UN-WFP)	 AUSTRALIA : PARK HOME/RESORT 2 BED ROOMS	 AUSTRALIA : PARK HOME/RESORT 2 BED ROOMS
 AUSTRALIA : PARK HOME/RESORT 3 BED ROOMS	 AUSTRALIA : PARK HOME/RESORT 2 BED ROOMS	 THAILAND : DOW CHEMICAL OFFICE	 THAILAND : 2-STOREY HOSPITAL/CLINIC	 THAILAND : OFFICE BUILDING
 THAILAND : OFFICE BUILDING	 THAILAND : OFFICE BUILDING	 THAILAND : ROYAL THAI NAVY MARITIME SECURITY CENTER	 THAILAND : TAKHI ROYAL THAI AIR FORCE BASE	 THAILAND : OFFICE BUILDING
 THAILAND : PUBLIC WELFARE HOME	 JAPAN : 2002 WORLD'S CUP SOCCER MEETING ROOM	 JAPAN : 2002 WORLD'S CUP SOCCER CANTEEN	 JAPAN : 2002 WORLD'S CUP SOCCER MEETING ROOM	 JAPAN : EXCEL HUMAN BUILDING SHOWROOM & SHOP
 JAPAN : NTT DOCOMO MOBILE PHONE SHOP	 JAPAN : SAVE ON CONVENIENCE STORE	 JAPAN : MINI STOP MINI MART	 THAILAND : McDONALD'S FAST FOOD SHOP	 THAILAND : KFC FAST FOOD SHOP
 THAILAND : DRUG STORE KIOSK	 THAILAND : AM PM KIOSK	 INDONESIA : PREFABRICATED EMERGENCY HOUSE 20,000 UNITS	 INDONESIA : PREFABRICATED EMERGENCY HOUSE	 TAIWAN : 2-STOREY HOUSE
 JAPANESE GOVERNMENT EMERGENCY HOUSE	 JAPAN : MULTI-USE STORAGE UNIT	 HONG KONG : TOILET UNIT	 JAPAN : OUTDOOR EXHIBITION TOILET UNIT	 THAILAND : THE 13 TH ASIAN GAME (BANGKOK 1996) TOILET UNIT
 THAILAND : ROYAL BRITISH EMBASSY TOILET UNIT	 THAILAND : CDMA PROJECT	 THAILAND : HUAWEI PROJECT	 THAILAND : AIS PROJECT	 THAILAND : AIS PROJECT